

Blackbody User Manual

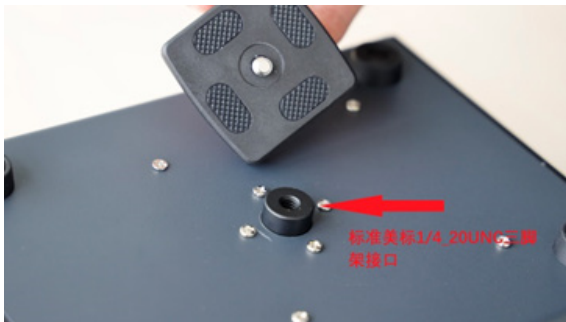

1. Installation



The product has the American Standard 1 / 4-20unc tripod interface (the upper part and the lower part have interfaces), which is convenient for customers to install;

There are four cushions at the four corners of the bottom, which can be used for horizontal placement of products.



Tripod installation effect drawing

2. Quick Setup

1. Connect the blackbody to the AC220V power supply and turn on the power switch.



2. The power indicator is on, and the display shows the default temperature of 35.0°C , Set the blackbody temperature to 40°C by adjusting the up and down buttons. After 5 minutes of preheating, the machine is stable and can be used normally.



3. Display panel

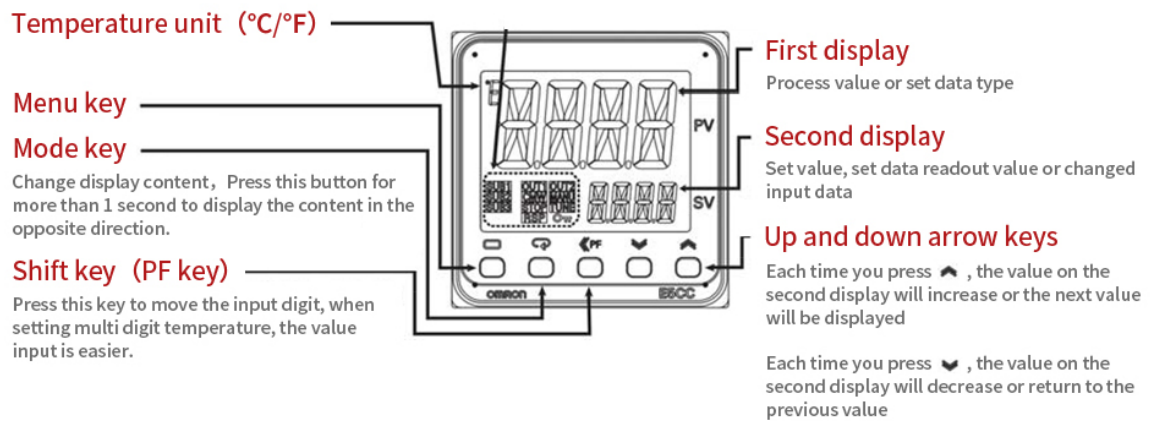

4. Matters needing attention

1. Please ensure the correct power input
2. Please do not touch the black target area to prevent scalding
3. It is better to use the product at room temperature of about 25°C to ensure the accuracy of the equipment
4. Avoid using in humid and over temperature environment, otherwise it will affect the accuracy of the equipment

5. Product parameters

Blackbody	
Working Voltage	AC100V~240V
Max Power Dissipation	260W
Working environment Temperature	0℃ ~+40℃
Settable Temperature	RT+5℃ ~100℃
Calibration Temperature	35℃ ~40℃
Emissivity	0.97±0.02
Temperature Resolution	0.1℃
Settling Time	≤5min
Temperature Accuracy	±0.2℃ @36℃
Temperature Stability	± (0.1℃ ~0.3℃) /h
Effective radiation surface	100mm*80mm
Dimensions (LxHxW)	L195*W150*H110

Packing list:

Blackbody, power cord (one), product manual

After-sales service:

The warranty period of this product is 1 year.

FOTRIC INC.

www.fotric.com

info@fotric.com